

NOTE: LCDOT design detail for recently adopted standard typical roadway section. The design provides, on an urban section, three feet of additional pavement outside the travel lane in addition to a Type B-6.24 curb and gutter. The revised standard section became effective on August 1, 2015. The standard shall apply to all LCDOT roadway projects for which engineering is or was initiated on or after August 1, 2015. The standard may be applicable retroactively to projects for which Phase I engineering was initiated prior to August 1, 2015. The determination of applicability to a project in Phase I engineering prior to August 1, 2015 will be made by the County Engineer in consultation with the respective Project Manager.

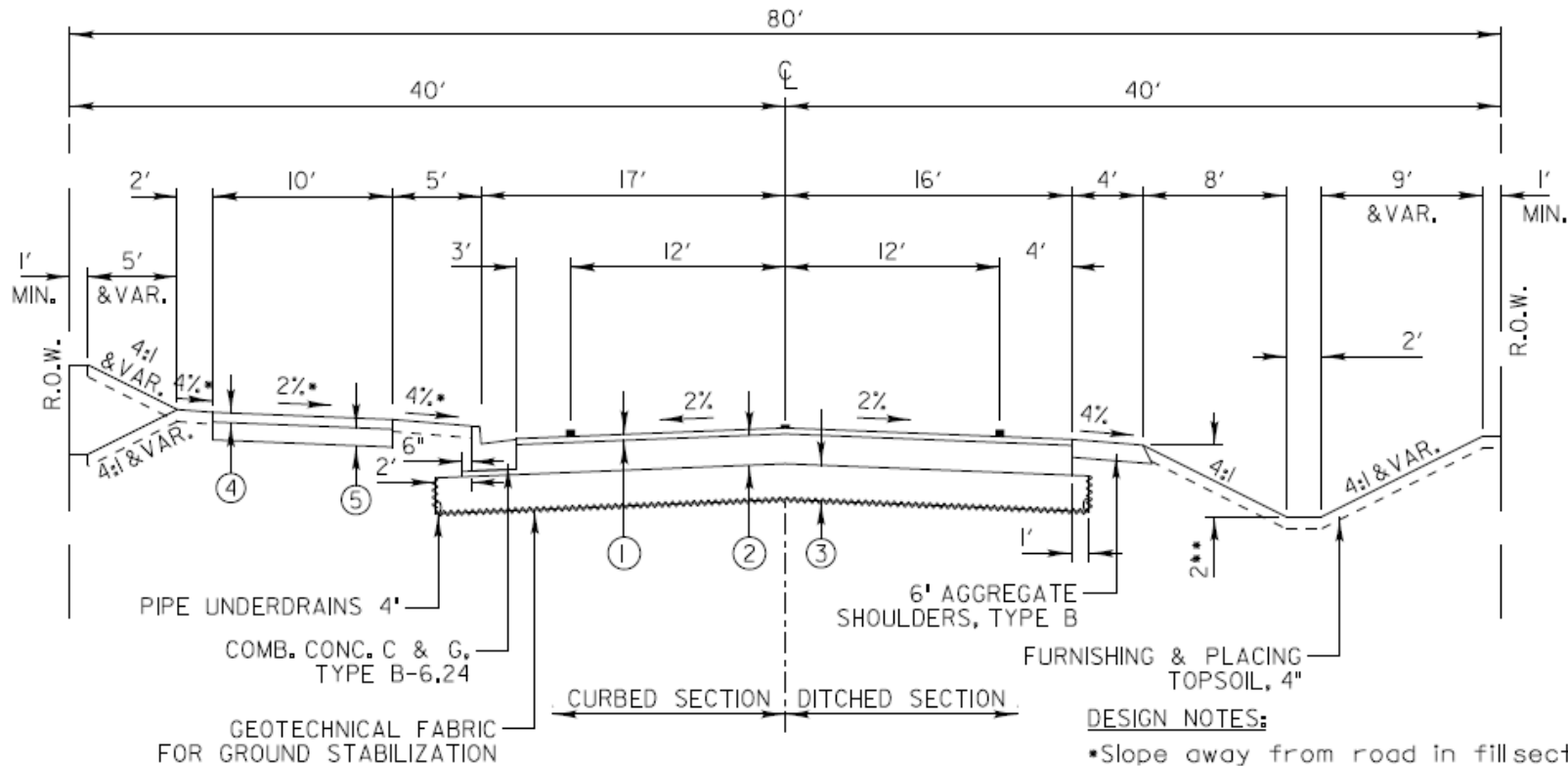

- ① 2" HOT-MIX ASPHALT SURFACE COURSE, MIX 'D', N70, ***
- ② 10" HOT-MIX ASPHALT BINDER COURSE, IL-19.0, N70, ***
- ③ AGGREGATE SUBGRADE, 12"
- ④ 3" HOT-MIX ASPHALT SURFACE COURSE, MIX 'D', N50
- ⑤ AGGREGATE BASE COURSE, TYPE B, 6"

If the Bike Path is being constructed in conjunction with the road improvement, then the Hot-Mix Asphalt mixes shall be the same as those used on the road in order to avoid multiple mix requirements.

DESIGN NOTES:

- *Slope away from road in fill sections
Slope toward road in cut sections
 - ** Need SS or PU when ditch is less than 18" deep.
SS in ditch, PU in shoulder.
 - *** Pavement materials & thicknesses are for an average county road and will vary with each project's pavement design.
- Due to proximity of C&G to through lane, the curbed half of this typical section is intended for posted speeds of 45 mph or less.

SCALE:
HORIZONTAL 1" = 10'
VERTICAL 1" = 5'

REVISIONS	DATE
Changed BP to 3" Surface	5/1/2008
4' PAVED SHOULDER ADDED	9/21/2010
Modified Agg./Binder Shoulder Ends	3/1/2011
CHANGE TO MIX 'D'	2/20/2012
Revised Type A to Type B Aggregate	12/20/12
Curbed Section Shldr Increased to 3'	8/3/2015



APPROVED BY: M. G. ZEMAITIS
DATE: April 1, 2007

**TYPICAL 2 LANE SECTION
with ADJACENT
MULTI-USE PATH**

LC4001